

comfyer[®] baby

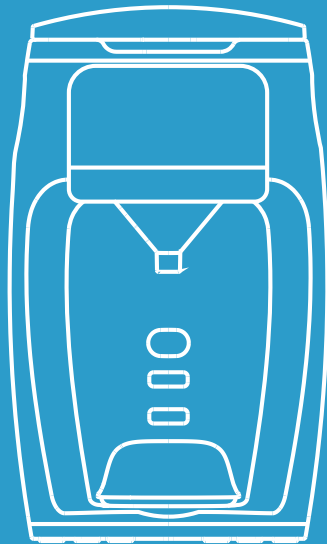

Smart Baby Formula Maker

User Manual

Model NO.: BF01



CONTENTS

Introduction	01
Safety Precautions	02
Product Description	04
Set-up Instructions	07
Formula Preparation	09
Cleaning Precautions	13
Troubleshooting	14
Environmental Statement	15
Product Specifications	15
Warranty & Support	16

Introduction

Thank you for purchasing the Comfyer BF01 Smart Baby Formula Maker. For proper usage and maintenance, please read this user manual carefully before using, especially the Safety Precautions, and save this user manual for further use.

For your baby's health, we highly suggest you to:

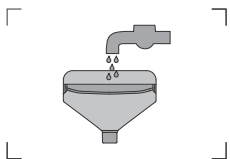

1 Clean the Funnel after every use.

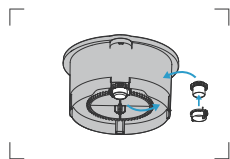

2 Clean the Powder Nozzle unit once a day. The Nozzle and its lock can be removed and cleaned easily.

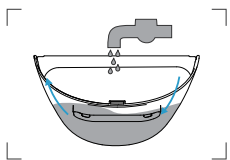

3 Fill the Water Tank with cold boiled water or purified water, and clean inside of the Water Tank regularly.

Note: Do not add more than 40 °C/ 104 °F water into the water tank, otherwise the water tank may cause the deformation!

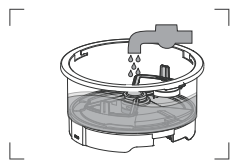

4 Clean the Powder Container and its parts after using up the powder. Ensure all parts are completely dry before assembling.

Safety Precautions

1. Please do not place the appliance on uneven surface.
2. The appliance is X power connection, and make sure the voltage of the appliance is the same as your local supply.
3. In order to prevent accidents or injuries, do not use the appliance if the power cord, the mains plug or other component is damaged, and do not repair or disassemble the appliance by yourself. Please contact comfyer Customer Service for help.
4. Please do not remove the Funnel, the Powder Container or the Water Tank while the appliance is working.
5. Parts contacting with water and formula are made of food-grade approved materials. To avoid deformation or damage, do not put any parts of the appliance into high temperature equipment including but not limited to microwave oven or sterilizer.
6. Please do not put any parts of the appliance in dishwasher.
7. Please clean detachable parts like the Funnel, the Powder Container and the inside of Water Tank regularly. Do not clean them by boiling, firing or heating. **Do not use more than 70 °C/158°F water** to clean the water tank, otherwise the water tank may cause the deformation!
8. Please unplug the appliance before cleaning. Do not immerse the appliance in water or other liquid.
9. Please do not use coarse dishcloth, steel wool or corrosive liquid (such as gasoline or acetone) to clean the appliance.
10. Please keep children away from the appliance and the power cord.
11. To avoid contamination or damage of the Powder Container, please do not fill other substance except dry, instant powder.

12. To avoid contamination or damage of the Water Tank, please do not fill other liquid except cold boiled water or purified water.
13. The appliance is intended for household or personal use only.
14. To avoid malfunction caused by overheating, please place the appliance in a cool, dry place instead of exposing it to direct sunlight.
15. Powder Container and other parts are made from the food- grade material tritan, please do not disinfect them at high temperature, such as steam, water boiling, ultraviolet radiation, etc..
16. Due to the different environment, there may be bubbles on the surface of milk. Please wait until the bubbles disappear before giving it to infants.
17. Turn off the machine before replacing accessories.
18. This appliance can be used by children aged from 8 years and above and persons with reduced physical, sensory or mental capabilities or lack of experience and knowledge if they have been given supervision or instruction concerning use of the appliance in a safe way and understand the hazards involved. Children shall not play with the appliance. Cleaning and user maintenance shall not be made by children without supervision.

WARNING: Do not use the appliance if the surface is cracked.

Product Description

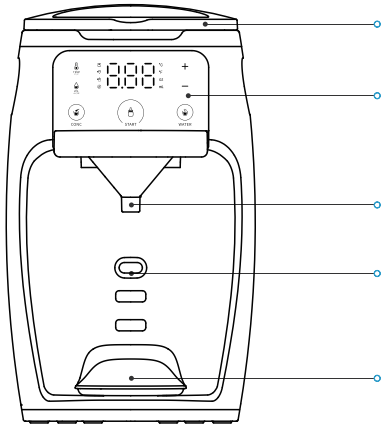

Appliance

Powder container:

To store formula powder

Touch panel:

To adjust water temperature, formula volume, concentration and control the appliance

Funnel:

The place where water and powder are mixed

Bottle sensor:

To detect bottle

Adjustable tray:

3-level tray working with different bottles

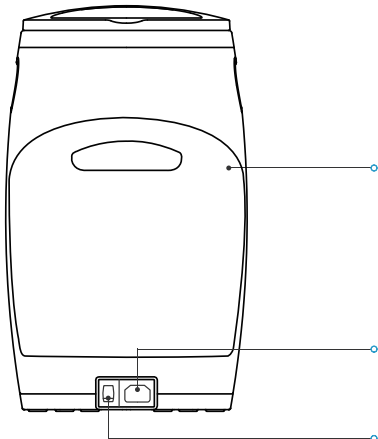

Water tank:

To store cold boiled water (1.5L max.)

Please don't add water above 40°C/104°F into the water tank to prevent deformation.

Socket:

To connect the mains plug

Power switch:

To turn on or off the product power

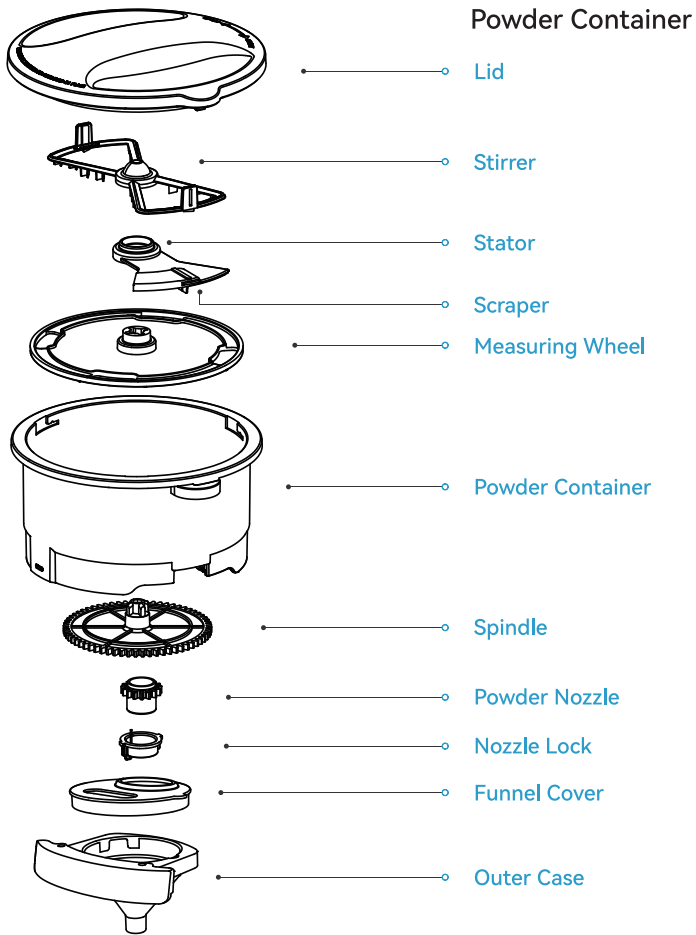

Use your phone to scan the QR code below to watch the Powder Container's Assembly or Disassembly demo video:



Assembly



Disassembly

Panel Display

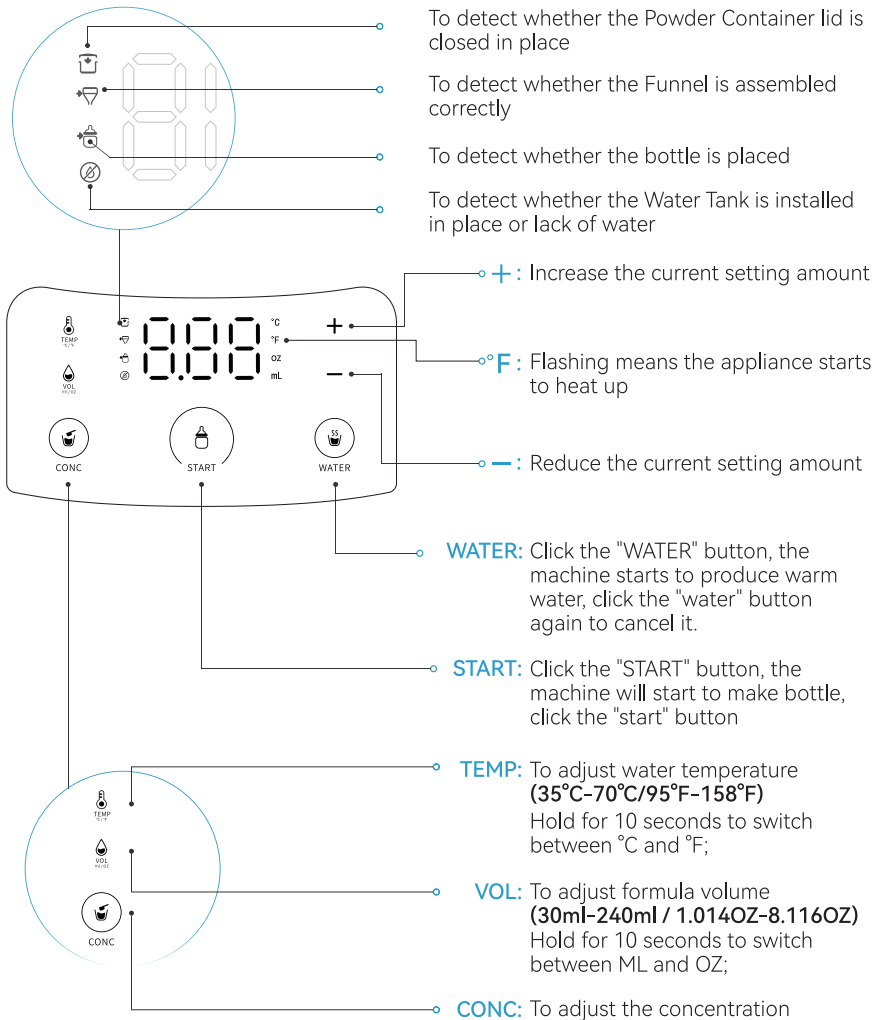

Set-up Instructions

Note: After hand washing these parts, make sure they are all completely dry before assembly. Set-up and cleaning videos available at www.comfyer.net/machines.

Follow these steps before doing anything else:

- Place the comfyer BF01 on the counter or other level surface and turn it around so the back is facing you.
- Hold the handle and tilt the Water Tank, then fill cold boiled water or purified water, do not add more than 40 °C/ 104°F water into the water tank to prevent deformation.
- When the machine is turned on for the first time, the "CLE " will be displayed on the panel. You need to click the "CONC" button to clean and activate the machine. It will automatically enter the cleaning mode and 30ml of water will be discharged each time, so get a cup or bottle larger than 10oz and place it under the funnel.

Now you can set-up your new comfyer BF01.

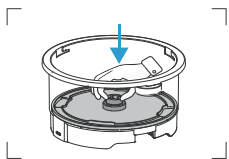

a Place the measuring wheel flatwise.

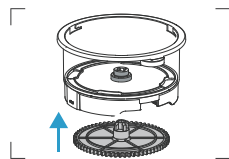

b Insert the spindle properly.

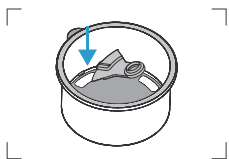

c Place the stator (scraper downward) and insert the jut into the slot above the powder container hole.

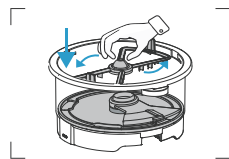

d Twist the stirrer anticlockwise to be tight enough.

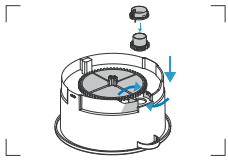

e Place the powder nozzle in the hole (on the bottom of the container). Attach the nozzle lock, and twist it clockwise to fasten down.



f Turn the lid clockwise to close in place.

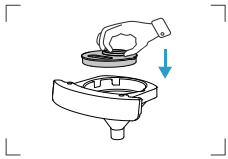

g Make sure the piece that sticks out on the cover fits into the slot on the edge of the Funnel body, then in the appliance.



h Hold the front part of the tray and insert it into the slot.

Formula Preparation

Step 1. Fill Formula Powder

Fill formula powder, make sure that the powder is filled between the MIN & MAX lines on the powder container.

Note: Ensure the Powder Container is completely dry before filling formula powder.

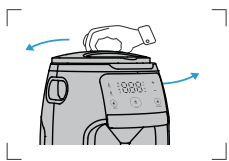

a Turn the lid to open.

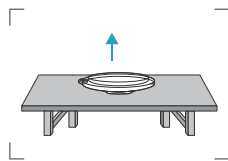

b Keep the lid upward.

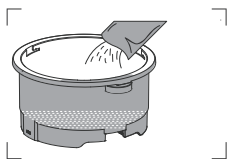

c Fill formula powder, and keep the powder level above the MIN line.

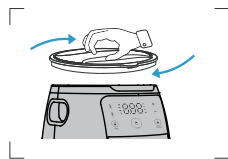

d Turn the lid to close.

Step 2. Fill Cold Boiled Water or Purified Water

Note: Do not fill other liquid except cold boiled water or purified water. Please do not add more than **40 °C/104°F** water into the water tank to prevent deformation.

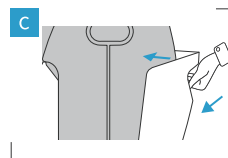
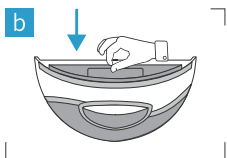
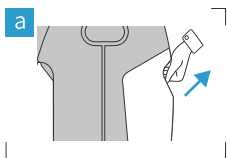

Step 3. Place a Bottle on the Tray

Note: Ensure the bottle is sterilized and clean before use.

Adjust the tray according to different bottle sizes, making sure the bottle can cover the sensor.

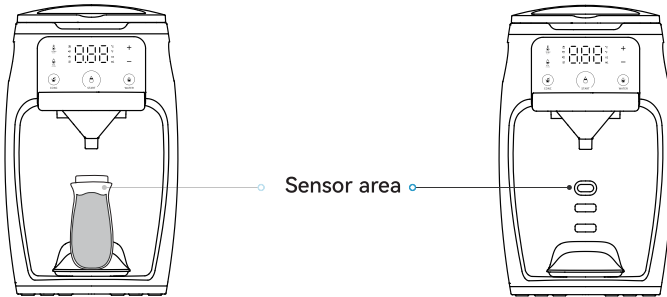

Step 4. Check the Assembly

Note: Equipped with the safety sensors, the appliance begins to work only when water is sufficient, and all parts are assembled properly.



Powder Container indicator is flashing: The Powder Container may be assembled incorrectly.

What to do: Close and tighten the lid.



Funnel indicator is flashing: The Funnel may be assembled incorrectly.

What to do: Take the Funnel out and place it into the appliance again.



Bottle indicator is flashing: Bottle may be placed incorrectly.

What to do: Adjust the tray and make sure the bottle can cover the sensor.



Volume indicator is flashing: Water is not enough or the Water Tank is misplaced.

What to do: Make sure the water is over the MIN line, and assemble the Water Tank correctly.

Now you're ready to make your first bottle of formula.

Step 5. Identify Formula Concentration

Two methods to identify the formula concentration of your baby's milk powder:

1. Log on to comfyer's official website: <https://www.comfyer.net/formula>, enter brand name or bar code number and other information of your baby's milk powder, find the concentration value, press the "CONC" button on the BF01's touch panel and press the "+" or "-" button to adjust the concentration value.

Milk Powder Database

Q

2. Download **comfyer** APP by searching "comfyer" in APP Store or Google Play. Click the scan button and scan the QR code on the milk powder can, then you will get all information for the formula powder.

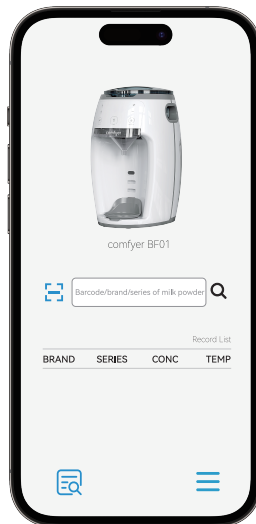
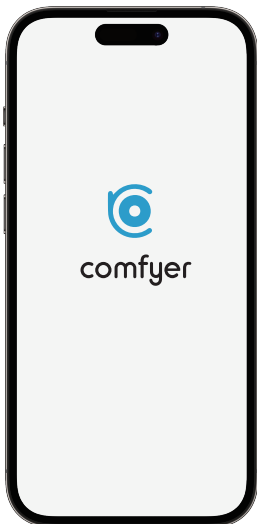

If none of the above methods can query your formula powder concentration value, please contact comfyer's official customer service staff by email at support@comfyer.com.

Step 6. Cleaning and Activation

When the machine is turned on for the first time, the "CLE " will be displayed on the panel. You need to click the "CONC" button to clean and activate the machine.

Note: Every time the machine is restarted or if there is 6 hours without use, it will enter the cleaning mode ("CLE" will be displayed on the panel) automatically and 30ml of water will be discharged each time. You will need to click the "CONC" button to clean and activate the machine.

Step 7. Prepare Formula Bottle



- a Setup the temperature:** Click the "Temp" button, and click the "+" and "-" buttons to adjust temperature.



- b Setup the volume:** Click the "Vol" button, and click the "+" and "-" keys to adjust water volume.

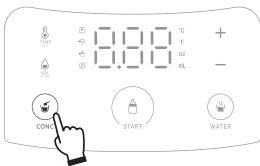

- c Setup the concentration:** Click the "Conc" button, and click the "+" and "-" buttons to adjust to the desired concentration.

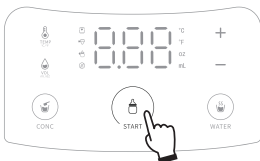

- d Prepare formula bottle:** After pressing the "Start" button, the formula will be done in 3-8 seconds.

Note:

- The heater needs to be preheated when used for the first time or after being idle, please wait patiently for 3-10 seconds.
- The water supply system needs to be activated when used for the first time or after being idle, please long press the "CONC" button until the machine discharges water.
- Due to the different environment, there may be bubbles on the surface of milk. Please wait until the bubbles disappear before giving it to infants.

Cleaning Precautions

Disassemble and cleaning videos available at www.comfyer.net/machine.



Funnel: Clean the Funnel after every use

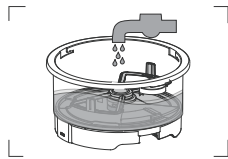

Powder Container: Clean the Powder Container and its parts after using up the powder

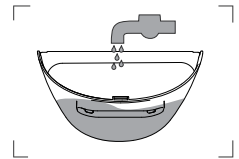

Water Tank: Clean inside of Water Tank regularly.

Please clean the funnel and powder container with hot water (**below 80 °C/176°F**), then dry them with a dry, hygienic cloth.

Please do not use more than **70 °C/ 104°F** water to clean the water tank to prevent deformation.

Please do not disinfect food-grade materials at high temperature, such as steam, water boiling, ultraviolet radiation, etc..

Troubleshooting

Error Display	Situation	Cause	Solution
C 01	Beeps 3 times after pressing Start/Water button	Boiler temperature is too high. The water tank is short of water and the water sensor fails. Other circuit failure	Cool down the water or refill cooler water, and try again after 3mins. Check whether the water sensor is normal
C 02	Beeps 3 times after pressing Start/Water button	The water temperature in the water tank is lower than 10°C/ 50°F or higher than 45°C/ 113°F	Keep the water temperature in the water tank within the range of 10~45°C (50°F~113°F); replace the cold water and operate again after 5 minutes
C 03	Beeps 3 times after pressing Start/Water button	The water temperature in the water tank is too high, and is more than 5°C/ 41°F higher than the current set temperature	Cool down the water or refill cooler water, and try again after 3mins
C 04	Beeps 3 times after pressing Start/Water button	The powder container is deformed. Abnormal installation results in high load of quantitative motor	Clean the powder container; Reinstall the powder container; Restart the machine; Recommend contacting after-sales customer service
C 05	Beeps 3 times after pressing Start/Water button	Boiler temperature is too high. The water tank is short of water and the water sensor fails. Other circuit failure	Check whether the home voltage is stable Check the water tank; Restart the machine; Recommend contacting after-sales customer service
E 01	Beeps 3 times after pressing Start/Water button	The power cord or socket is not plugged in securely. The input voltage is unstable	Check whether the voltage at home is stable. Check whether the power cord or socket is plugged in tightly. Contact Customer Service
E 02	Beeps 3 times after pressing Start/Water button	The heating unit NTC is abnormal	Contact Customer Service
E 03	Beeps 3 times after pressing Start/Water button	The cold water NTC is abnormal	Contact Customer Service
Numerical display range: 60~110	Click the "+" or "-" button to increase or decrease the value by "1"	Misoperation leads to engineering mode	click "water" button to return to normal
Numerical display range: 000	The motor turns one turn	Misoperation leads to engineering mode	click "water" button to return to normal
The displayed flashes	The machine beeps 3 times when you click the "Start" or "Water" button.	When you set the "temperature" from high temperature to low temperature within a short period of time At this time, the heater inside the machine is kept at a higher temperature and can't be cooled down instantaneously.	wait for the heater to cool down or change the "temperature" to high temperature again.

Environmental Statement

1. This appliance meets the standard of The Measures for the Administration of the Restricted Use of the Hazardous Substances Contained in Electrical and Electronic Products.
2. During the period of environmental protection, the appliance is free from problems such as harmful substance leakage or effusion as long as it's under normal household use.
3. Environmental protection period of the appliance is 10 years, which is valid only when the appliance is under normal household use.

Product Specifications

Name	Smart Baby Formula Maker	Power container capacity	400g	Water Tank capacity	1.50L
Model number	BF01	Rated Voltage	100~120V	Rated Power	1600W
Dimensions	216x264x362mm	Rated Frequency	50/60Hz	N.Weight	4.0kg
Materials		Tritan / Food-grade silicon / ABS / Food-grade PP / AS			

Warranty & Support

Warranty

The comfyer BF01 Smart Baby Formula Maker comes with a full 12 months limited warranty.

If you register your product on our official site (www.comfyer.net/register), you can extend the warranty to 18 months.

Support

If you have any questions regarding your product, please do not hesitate to drop us an email at support@comfyer.net. Queries are typically answered within 12-24 hours.

Your opinion matters

comfyer is firmly committed to always improving our products, services, and user experience.

If you have any thoughts on how we can do even better, we welcome your constructive feedback and suggestions. Connect with us today at support@comfyer.net.

comfyer[®] baby

Smart Baby Formula Maker

BF01



www.comfyer.net

Made in China